

Housing $\phi 42 \times L28$ mm DC Brushless Motor B4228S

OUTPUT : 50W~200W (APPROX) **Outer Rotor** **High Speed**

Bearing TYPE : ボールベアリング /Ball Bearing

WEIGHT (APPROX) : 140g

代表的用途 /Typical Application

家電機器 / 白物家電、調理家電、ファン、理美容家電 / FA 機器 / AGV、搬送機器

医療機器 / ポンプ、血圧計、攪拌器、分離器 / DIY / 電動ポンプ、電動ドライバ

Household App / Home Electric App, Electric Cooker, Fan, Shaver, Hair Curler

Factory Automation Equipment / AGV, Motion Control /

Medical App / Medical Pump, Blood Pressure Meter, Medical Stirrer/ DIY App / Electric Pump, Screw Driver



Characteristic : CW/CCW, Signal function available (FG), PWG speed control, Locked rotor protection, IC Heat protection, Life expectancy 10,000-30,000hrs,

Motor Parameter

No.	Standard Model No.	Product No.	Outline Size			Rated Voltage (V)	No Load		at Max Efficiency				at Stall			Configuration	
			Motor OD (mm)	Housing Length (mm)	Shaft OD (mm)		No Load Speed (rpm)	No Load Current (A)	Rated Speed (rpm)	Rated Current (A)	Rated Torque (mN·m)	Output (W)	Starting				
													Starting Torque (mN·m)	Starting Current (A)			
1	B4228S	-S01	42.0	28	3	18	31500	1.10	29000	8.03	40	408	120.86	483.57	4931	84.75	High Speed Outer Rotor Ball bearing
2		-S02	42.0	28	3	24	27000	0.72	24400	7.46	60	612	153.10	556.90	5679	63.33	
3		-S03	42.0	28	3	36	21500	0.38	19100	4.52	70	714	139.67	598.57	6104	35.80	
4		-S04	42.0	28	3	48	25000	0.33	21900	4.42	80	816	183.11	660.23	6732	34.07	
5		-S05	42.0	28	3	AC220	24000	0.05	17850	0.84	100	1020	186.92	381.08	3886	3.00	

OUTLINE & Inner Driver I/O

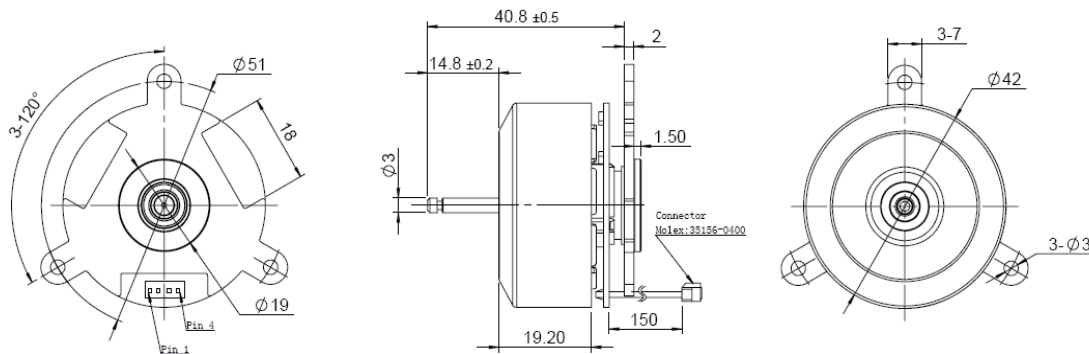

Typical Performance

B4228S-S01 (18V)

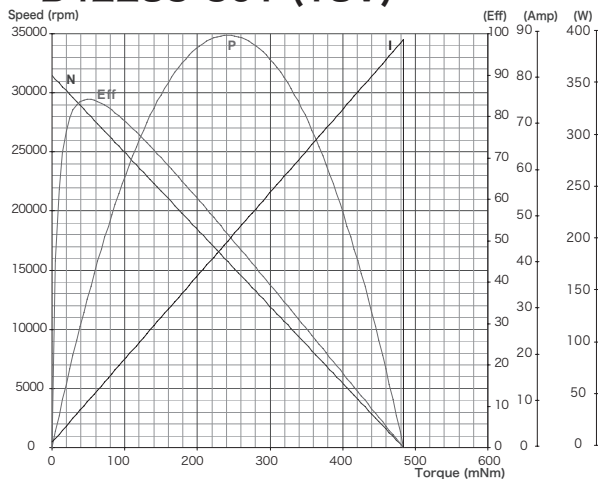

B4228S-S04 (48V)

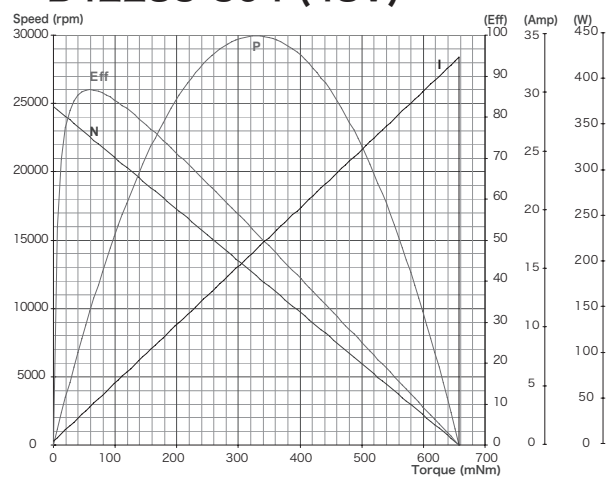

Japan Magnets.,Inc

Head Office / Japan Bldg 4F, 1-1646-2, Kamikawa, Suwa, Nagano, Japan zipcode 392-0021

Tel /+81-266-56-1021

Fax /+81-266-56-1430

HP / <http://www.jmi-motion.com>