

Housing ϕ 21~24mm DC Brush Motor xFF-270/ xFK-280

OUTPUT : 1W~10W (APPROX)

BRUSH TYPE : 貴金属ブラシ /Precious Metal Brush Motor(FF-270)

BRUSH TYPE : カーボンブラシ /Graphinte Brush Motor(FK-290/ RK-280/ FK-280))

WEIGHT(APPROX) : 36g(FK-280)

代表的用途 /Typical Application

白物家電、血圧計、ヘアドライヤー /
事務機器、インクジェットプリンタ、レーザプリンタ、複写・複合機 /
自動車電装部品 / ドアロック、ドアミラー格納、ドアミラーレギュレーター

Household App /
Office Automation Equipment / Printer, Scanner,
Automotive Equipment / Door Lock, Door Mirrow Regulator for Car

Motor Parameter

No.	Standard Model No.	Product No.	Outline Size			Rated Voltage	No Load		at Max Efficiency				at Stall			
			Motor OD	Housing Length	Shart OD		No Load Speed	No Load Current	Rated Speed	Rated Current	Rated Torque		Output	Starting Torque		Starting Current
			(mm)	(mm)	(mm)		(rpm)	(A)	(rpm)	(A)	(mN·m)	(g·cm)	(W)	(mN·m)	(g·cm)	(A)
Typical Grade xFF-270																
128	DC-TFF-270PA	3065	21.2	30.1	2.0	2.4	6589	0.14	5610	0.80	2.18	22.20	1.28	14.70	150.00	4.60
Typical Grade xFK-290																
129	DC-TFK-290PA	07670	21.2	42.5	2.0	110.0	11600	0.01	9780	0.04	3.75	38.20	3.94	24.50	250.00	0.26
Typical Grade xRK-280																
130	DC-TRK-280PA	3545	23.8	30.5	2.0	3.7	13690	0.38	11810	2.38	4.44	45.30	5.49	32.30	330.00	15.00
131	DC-TRA-280SA	16195			2.0	4.5	3570	0.05	2879	0.20	1.81	18.37	0.54	9.31	95.00	0.87
132	DC-TRU-280RA	2590			2.0	3.0	7038	0.11	5871	0.56	1.95	19.87	1.19	11.76	120.00	2.84
133	DC-TRK-280SA	2875			2.0	3.0	6500	0.17	5450	0.88	2.68	27.40	1.53	16.66	170.00	4.60
Typical Grade xFK-280																
134	DC-TFK-280PA	3356	24.0	30.5	2.0	3.0	8200	0.20	7055	1.23	3.55	36.20	2.63	25.50	260.00	7.60
135	DC-TFK-280SA	3728			2.0	3.0	18166	0.61	13989	2.02	2.24	22.90	3.30	9.80	100.00	6.80
136	DC-TFK-280SA	3157			2.0	7.2	21040	0.34	17999	2.00	4.39	44.86	8.29	29.40	300.00	11.50
137	DC-TFA-280SA	2670			2.0	3.0	7396	0.15	6128	0.72	2.18	22.28	1.40	12.74	130.00	3.50
138	DC-TFC-280PA	18200			2.0	12.0	10330	0.08	8737	0.45	3.97	40.50	3.63	25.77	263.00	2.50
139	DC-TFC-280PA	15270		30.6	2.0	13.5	7966	0.06	6706	0.31	4.00	41.10	2.83	25.50	260.00	1.70
140	DC-QFK-280DA	20150	24.2	30.5	2.0	12.0	12500	0.12	10600	0.67	4.77	48.63	5.29	31.16	318.00	3.70
141	DC-QFK-280DA	18180			2.0	12.0	11400	0.05	10100	0.39	3.28	33.44	3.47	28.67	292.50	3.00

Japan Magnets.,Inc

Head Office / Japan Bldg 4F, 1-1646-2, Kamikawa, Suwa, Nagano, Japan zipcode 392-0021

Tel /+81-266-56-1021

Fax /+81-266-56-1430

HP / <http://www.jmi-motion.com>

Housing $\phi 21 \sim 24$ mm DC Brush Motor xFF-270/ xFK-280

OUTLINE

DC-QFK-280DA

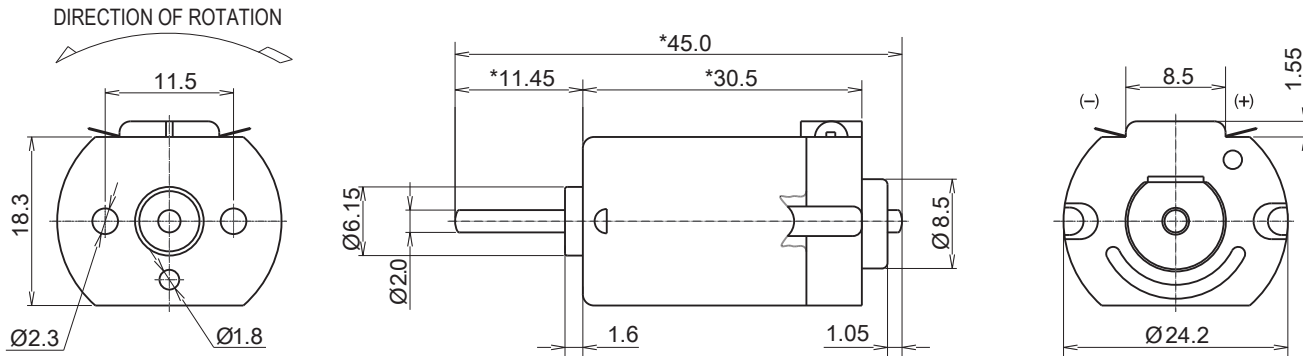

DC-QFK-260DA

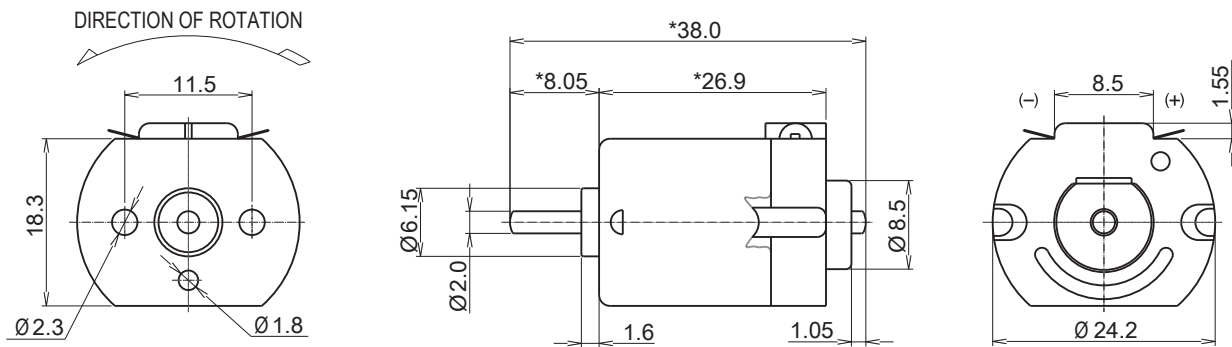

Typical Performance

DC-QFK-280DA-18180(12V)

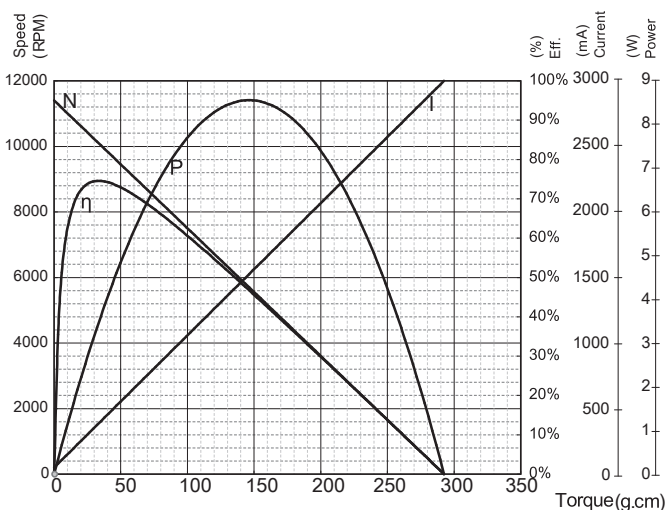

DC-QFK-260DA-12250(24V)

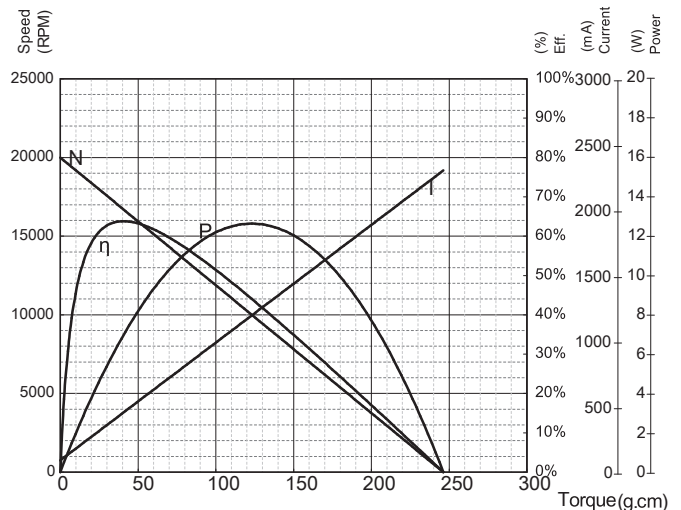

Japan Magnets.,Inc

Head Office / Japan Bldg 4F, 1-1646-2, Kamikawa, Suwa, Nagano, Japan zipcode 392-0021

Tel /+81-266-56-1021

Fax /+81-266-56-1430

HP / <http://www.jmi-motion.com>