

Housing ϕ 10mm DC Brush Motor xFF-M10/ M20/ M30

OUTPUT : 0.1W~7W (APPROX)

BRUSH TYPE : 貴金属ブラシ /Precious Metal Brush Motor

WEIGHT(APPROX) : 2.8g(FF-M10)/4.0g(FF-M20)/6.0g(FF-M30)

代表的用途 /Typical Application

オーディオ関連機器 / 車載用 CD プレーヤー、
光学機器 / デジタルカメラ、カムコーダ、
家電機器 / 精密測定器、小型模型、玩具 /

Audio&Visual Equipment / CarCD Player、
Digital Camera、Camcorder /
Household App /
Precision Instrument、Model&Toy

Motor Parameter

No.	Standard Model No.	Product No.	Outline Size			Rated Voltage	No Load		at Max Efficiency				at Stall			
			Motor OD	Housing Length	Shaft OD		No Load Speed	No Load Current	Rated Speed	Rated Current	Rated Torque		Output	Starting Torque		Starting Current
			(mm)	(mm)	(mm)		(rpm)	(A)	(rpm)	(A)	(mN-m)	(g · cm)	(W)	(mN-m)	(g · cm)	(A)
Typical Model FF-M10																
12	DC-QFF-M10SNAV	06175	10.0	11.6	1.0	3.0	18500	0.05	13300	0.12	0.09	0.91	0.12	0.31	3.20	0.31
13	DC-QFF-M10SNAV	08160			1.0	4.5	31000	0.07	24200	0.23	0.20	2.09	0.52	0.94	9.60	0.84
14	DC-QFF-M10SNAV	07195			1.0	5.0	28000	0.06	21300	0.18	0.18	1.84	0.40	0.75	7.70	0.57
15	DC-TFF-M10SA	06220		11.8	1.0	4.8	29440	0.07	21900	0.20	0.27	2.9	0.66	1.05	11.60	0.59
16	DC-TFF-M10PA	07180			1.0	5.0	20500	0.05	14692	0.12	0.2	2.3	0.34	0.75	8.00	0.32
17	DC-TFF-M10PA	08145			1.0	3.0	21900	0.07	16250	0.20	0.13	1.46	0.24	0.51	5.60	0.58
18	DC-QFF-M10LNAV	08160		12.6	1.0	4.5	26000	0.06	20500	0.20	0.22	2.21	0.46	1.02	10.40	0.75
19	DC-QFF-M10LNAV	09130			1.0	3.0	21000	0.07	16200	0.22	0.18	1.79	0.30	0.76	7.80	0.73
20	DC-QFF-M10LNAV	09155			1.0	4.5	26000	0.06	20700	0.23	0.25	2.60	0.55	1.24	12.70	0.91
Typical Model FF-M20																
21	DC-TFF-M20PA	1552	10.0	15.0	1.0	1.5	16460	0.15	12485	0.48	0.38	3.90	0.50	1.57	16.00	1.50
22	DC-TFF-M20PA	08160			1.0	3.5	34960	0.23	27727	0.87	0.60	6.10	1.74	2.94	30.00	3.40
23	DC-TFF-M20PA	07165			1.0	3.0	10920	0.03	8330	0.09	0.20	2.10	0.18	0.88	9.00	0.30
24	DC-TFF-M20WA	1551			1.0	6.0	27100	0.06	21640	0.24	0.41	4.20	0.94	2.06	21.00	0.95
25	DC-TFF-M20WA	1738			1.0	1.9	24000	0.22	18900	0.81	0.43	4.40	0.87	2.06	21.00	3.00
26	DC-QFF-M20NAV	13062			1.0	3.4	33000	0.13	26700	0.55	0.37	3.77	1.03	1.94	19.80	2.36
27	DC-QFF-M20NAV	10100			1.0	2.4	16800	0.06	13200	0.21	0.17	1.75	0.24	0.79	8.10	0.75
28	DC-QFF-M20NAV	07170			1.0	2.0	8000	0.03	6000	0.07	0.09	0.91	0.06	0.35	3.60	0.21
29	DC-QFF-M20LQAV	13065			16.8	1.0	3.6	23000	0.12	18800	0.54	0.56	5.76	1.11	3.12	31.80
Typical Model FF-M30																
30	DC-TFF-M30SA	06270	10.0	20.0	1.0	9.0	11400	0.04	7910	0.09	0.24	2.40	0.20	0.77	7.90	0.20
31	DC-TFF-M30SA	1639			1.0	1.5	15100	0.13	11828	0.47	0.35	3.60	0.44	1.67	17.00	1.70
32	DC-TFF-M30SA	1641			1.0	3.0	32000	0.18	26100	0.77	0.56	5.70	1.53	3.04	31.00	3.40

Japan Magnets.,Inc

Head Office / Japan Bldg 4F, 1-1646-2, Kamikawa, Suwa, Nagano, Japan zipcode 392-0021

Tel /+81-266-56-1021

Fax /+81-266-56-1430

HP / <http://www.jmi-motion.com>

Housing ϕ 10mm DC Brush Motor xFF-M10/ M20/ M30

OUTLINE

DC-QFF-M10SNAV

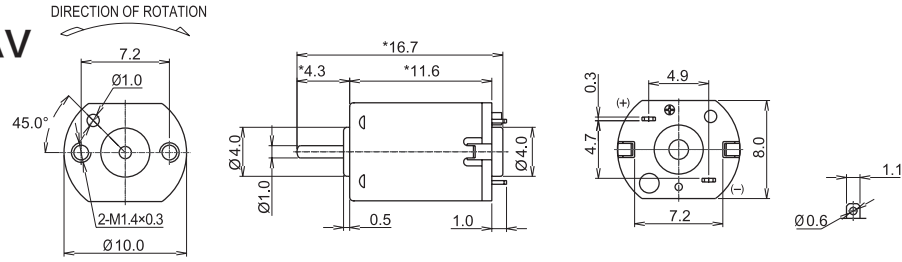

DC-QFF-M20NAV

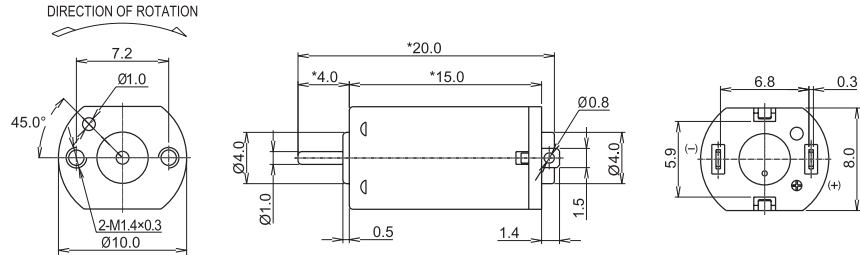

DC-QFF-M20LQAV

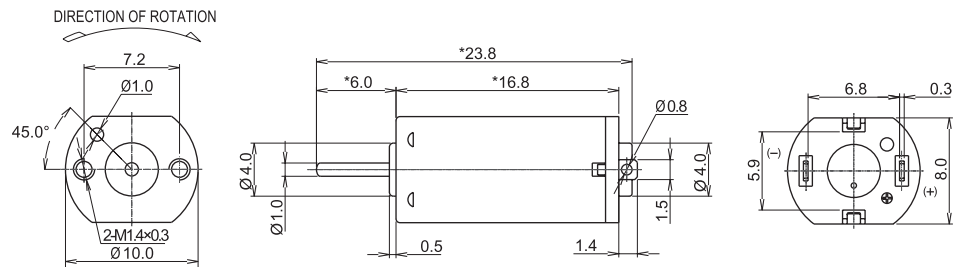

Typical Performance

DC-QFF-M10SNAV-08160(4.5V)

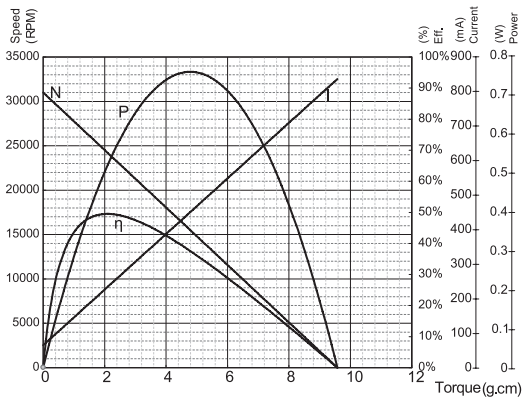

DC-QFF-M20NAV-13065(3.6V)

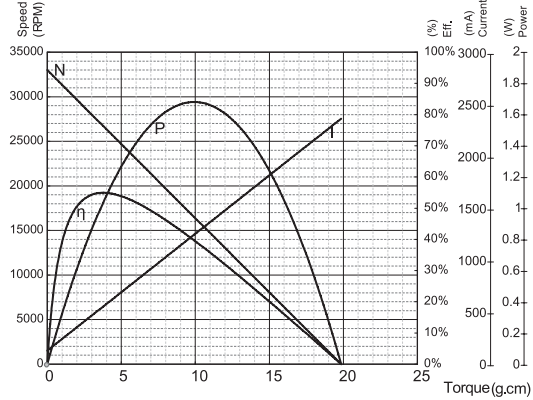

DC-QFF-M20LQAV-13065(3.6V)

