

Housing ϕ 24.4-27.7mm DC Brush Motor xRK-360/-365/-370

OUTPUT : 5W~15W (APPROX)

BRUSH TYPE : カーボンブラシ / Graphite Brush Motor

WEIGHT (APPROX) : 55g (RK-370PHV) / 55g (RK-360) / 54g (RK-365)

代表的用途 / Typical Application

白物家電、血圧計、ヘアドライヤー /
事務機器、インクジェットプリンタ、レーザプリンタ、複写・複合機 /
自動車電装部品 /

Household App /
Office Automation Equipment / Printer, Scanner,
Automotive Equipment /

Motor Parameter

No.	Standard Model No.	Product No.	Outline Size			Rated Voltage	No Load		at Max Efficiency				at Stall				
			Motor OD	Housing Length	Shart OD		No Load Speed	No Load Current	Rated Speed	Rated Current	Rated Torque		Output	Starting Torque		Starting Current	
			(mm)	(mm)	(mm)		(rpm)	(A)	(rpm)	(A)	(mN-m)	(g · cm)	(W)	(mN-m)	(g · cm)	(A)	
Typical Grade xRK-370																	
142	DC-QRK-370PHV	10800	24.4	30.8	2.0	24.0	5100	0.02	4300	0.08	2.89	29.51	1.30	18.74	191.20	0.45	
143	DC-TRK-370PH	4247			2.0	7.0	19300	0.94	16835	3.27	7.00	71.50	12.36	54.90	560.00	22.40	
144	DC-TRK-370PH	5129			2.0	8.4	38050	1.05	32466	6.12	10.93	111.50	37.19	74.48	760.00	35.60	
145	DC-TRK-370PH	4543			2.0	9.6	29513	0.71	25682	4.77	12.72	129.80	34.24	98.00	1000.00	32.00	
146	DC-TRK-370WH	4542			2.0	8.4	26800	0.58	23528	4.17	7.18	73.23	17.71	58.80	600.00	30.00	
Typical Grade xRK-360																	
147	DC-TRK-360PH	21120	27.7	32.5	2.3	9.0	10300	0.23	8610	1.40	6.47	66.00	5.80	39.20	400.00	5.80	
148	DC-TRK-365PH	12165			2.3	6.0	15580	0.09	12907	0.43	6.70	68.60	9.09	47.10	480.00	2.10	
149	DC-TRK-365SH	10495			2.3	24.0	7000	0.10	5734	0.21	45.80	47.00	2.74	25.20	260.00	1.50	
150	DC-TRK-365SH	16130			2.3	18.0	10800	0.16	8810	0.55	58.80	60.00	5.40	31.40	320.00	2.50	
151	DC-QRK-360DA	28085		32.6	2.3	7.2	12500	0.36	10400	1.76	7.16	73.09	7.80	42.18	430.40	8.60	
152	DC-QRK-360DA	10500			2.3	24.0	7000	0.05	5600	0.20	4.56	46.56	2.68	22.81	232.80	0.80	
153	DC-QRK-360DA	14280			2.3	12.0	6300	0.09	5000	0.34	4.27	43.59	2.24	21.36	218.00	1.36	
154	DC-QRK-365DA	18085			2.3	20.0	23200	0.24	19000	1.07	6.46	65.87	12.84	35.35	360.70	4.81	
155	DC-QRK-365DH	12190			2.3	24.0	10500	0.08	8400	0.33	4.98	50.80	4.38	25.21	257.20	1.32	
156	DC-QRK-365DH	20080			2.3	18.0	19400	0.22	16100	1.06	7.03	71.75	11.85	40.89	417.20	5.10	
157	DC-TRK-365PA	18108			32.7	2.3	14.0	9600	0.20	7726	0.82	8.60	87.80	6.97	44.10	450.00	3.40
158	DC-TRK-365SA	12190				2.3	24.0	10000	0.12	7960	0.40	53.80	55.00	4.50	26.10	270.00	1.40
159	DC-TRK-365SA	2558		2.3		13.5	18800	0.50	15700	2.30	65.10	67.00	11.00	38.20	390.00	10.50	
160	DC-TRK-365SA	2080		2.3		12.0	11750	0.35	9500	1.30	54.00	55.00	5.42	31.40	320.00	5.60	

Japan Magnets.,Inc

Head Office / Japan Bldg 4F, 1-1646-2, Kamikawa, Suwa, Nagano, Japan zipcode 392-0021

Tel / +81-266-56-1021

Fax / +81-266-56-1430

HP / <http://www.jmi-motion.com>

Housing ϕ 24.4-27.7mm DC Brush Motor xRK-360/-365/-370

OUTLINE

DC-QRK-370PHV

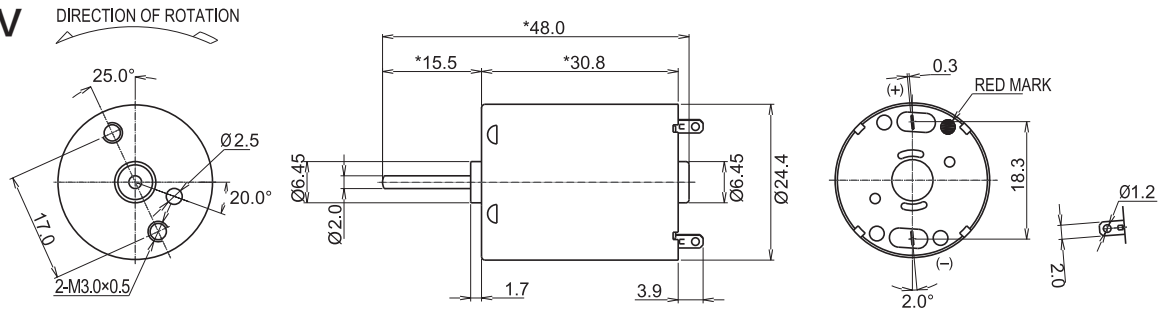

DC-QRK-360DA

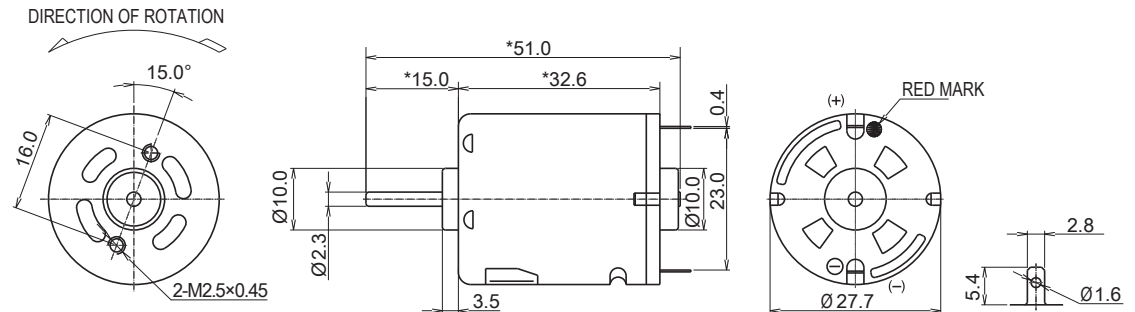

DC-QRK-365DA

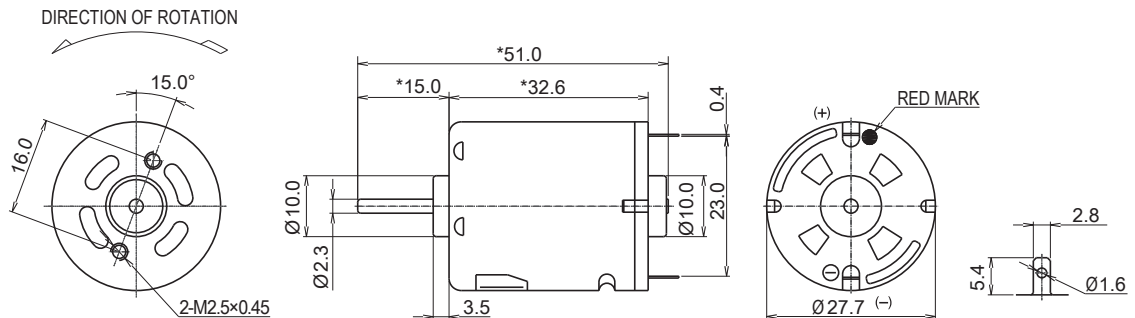

Typical Performance

DC-QRK-370PHV-10800 (24V)

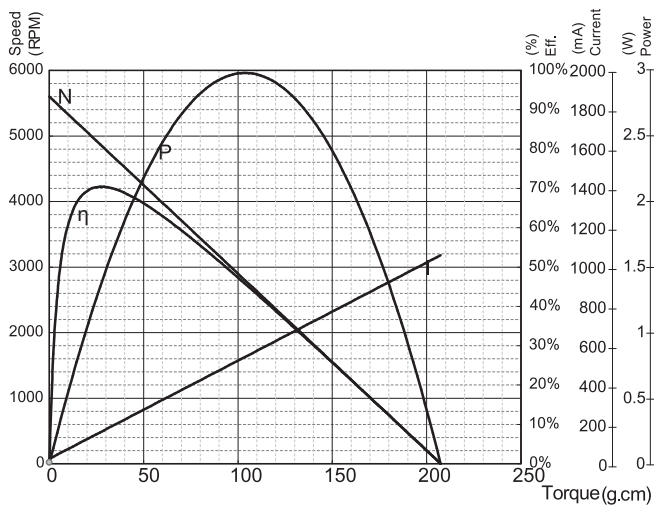

DC-QRK-360DA-28085 (7.2V)

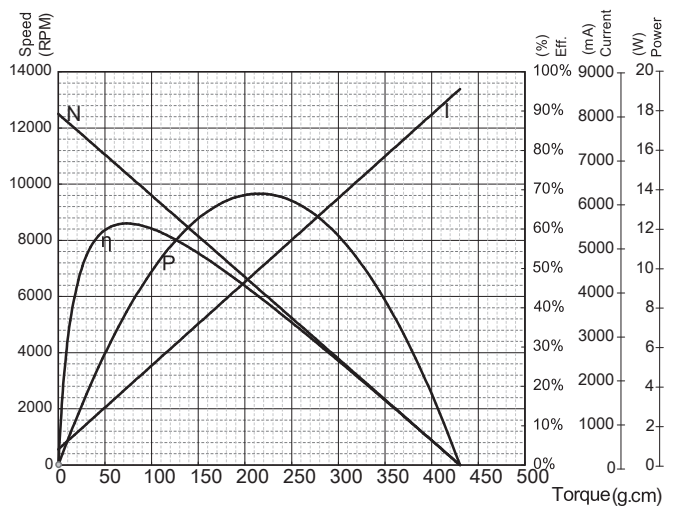

Japan Magnets.,Inc

Head Office / Japan Bldg 4F, 1-1646-2, Kamikawa, Suwa, Nagano, Japan zipcode 392-0021

Tel / +81-266-56-1021

Fax / +81-266-56-1430

HP / <http://www.jmi-motion.com>