

Housing ϕ 27-30mm DC Brush Motor xRK-380/390/ xFK-480

OUTPUT : 10W~20W (APPROX)

BRUSH TYPE : カーボンブラシ /Graphitie Brush Motor

WEIGHT(APPROX) : 62g(RK-380)/70g(RK-385)

代表的用途 /Typical Application

白物家電、血圧計、ヘアドライヤー /
事務機器、インクジェットプリンタ、レーザプリンタ、複写・複合機 /
自動車電装部品 /

Household App /
Office Automation Equipment / Printer, Scanner,
Automotive Equipment /

Motor Parameter

No.	Standard Model No.	Product No.	Outline Size			Rated Voltage	No Load		at Max Efficiency				at Stall			
			Motor OD	Housing Length	Shart OD		No Load Speed	No Load Current	Rated Speed	Rated Current	Rated Torque		Output	Starting Torque		Starting Current
			(mm)	(mm)	(mm)		(rpm)	(A)	(rpm)	(A)	(mN-m)	(g · cm)	(W)	(mN-m)	(g · cm)	(A)
Typical Grade xRK-380																
161	DC-QRK-380DA	40045	27.7	37.6	2.3	7.2	16200	0.50	14000	3.25	11.09	113.14	16.25	83.24	849.40	21.18
162	DC-QRK-380DA	12300			2.3	24.0	8000	0.07	6500	0.31	6.56	66.91	4.46	35.89	366.20	1.40
163	DC-QRK-385DA	20073			2.3	20.0	18300	0.21	15300	1.07	8.49	86.65	13.60	51.58	526.30	5.41
164	DC-QRK-385DH	12300			2.3	24.0	8000	0.07	6500	0.31	6.44	65.69	4.38	34.85	355.60	1.36
165	DC-QRK-385DH	16120			2.3	24.0	11800	0.12	9800	0.58	8.51	86.81	8.73	49.77	507.90	2.82
166	DC-TRK380PH	4045			37.8	2.3	6.0	11800	0.38	10310	0.38	8.67	88.30	9.63	68.60	700.00
167	DC-TRK380PH	2365		2.3		13.0	11250	0.30	9530	1.15	10.50	107.00	10.40	68.60	700.00	6.50
168	DC-TRK380PH	16120		2.3		12.0	4940	0.15	4000	0.45	5.88	60.00	2.48	31.40	320.00	2.20
169	DC-TRK380PH	4438		2.3		2.4	5860	0.68	4810	2.10	5.91	61.00	5.10	33.30	340.00	11.00
170	DC-TRK385SA	2262		2.3		24.0	22800	0.32	19300	1.50	10.60	108.00	21.40	68.60	700.00	8.00
171	DC-TRK-380PA	4045		2.3		6.0	12000	0.44	10245	2.56	10.00	102.00	10.80	68.60	700.00	15.00
172	DC-TRK-380PA	2080		2.3	12.0	8000	0.15	6750	0.70	7.65	78.00	5.40	44.10	450.00	3.50	
173	DC-TRK-380PA	16120	2.3	39.0	19900	0.20	16800	0.90	9.80	100.00	17.00	63.70	650.00	4.90		
Typical Grade xRK-390																
174	DC-TRK-390PA	21145	27.7	46.5	2.3	14.4	6700	0.10	5800	0.70	10.60	108.60	6.50	157.00	800.00	4.30
175	DC-TRK-390PH	1990			2.3	12.0	4570	0.15	3720	0.50	9.60	98.00	3.74	51.90	530.00	2.00
176	DC-TRK-390PH	5132			2.3	8.4	18100	0.85	20700	5.50	16.10	164.00	30.90	132.40	1350.00	40.00
177	DC-TRK-395PH	2650			2.3	24.0	17700	0.30	15700	1.90	13.80	141.00	23.00	117.60	1200.00	19.00
Typical Grade xFK-480																
178	DC-TFK-480WA	8012	30.0	46.5	3.17	9.6	36500	4.00	30852	20.00	42.50	433.20	150.00	274.50	2800.00	119.40
179	DC-TFK-480WA	8013			3.17	8.4	30500	5.50	25100	23.00	52.80	532.70	137.10	292.04	2980.00	95.00
180	DC-TFK-480PA	6728			3.17	8.4	17900	2.40	14960	12.00	26.20	273.00	42.00	162.68	1660.00	58.50
181	DC-TFK-480PA	7018			3.17	9.6	30600	3.80	25900	17.00	27.10	277.00	73.80	176.40	1800.00	85.00

Japan Magnets.,Inc

Head Office / Japan Bldg 4F, 1-1646-2, Kamikawa, Suwa, Nagano, Japan zipcode 392-0021

Tel /+81-266-56-1021

Fax /+81-266-56-1430

HP / <http://www.jmi-motion.com>

Housing ϕ 27-30mm DC Brush Motor xRK-380/390/ xFK-480

OUTLINE

DC-QRK-380/385

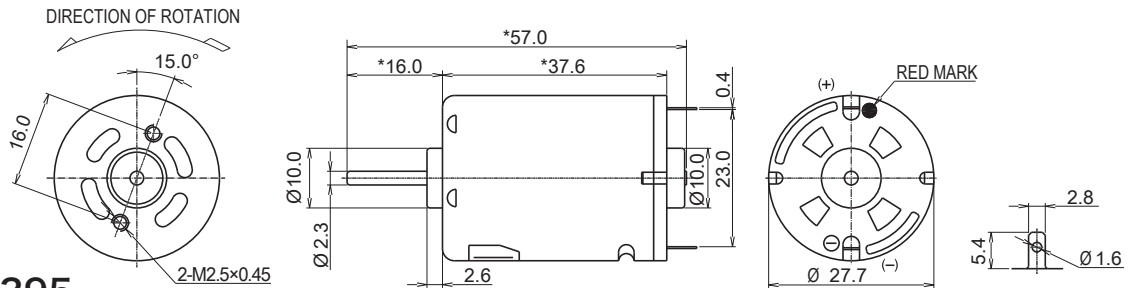

DC-QRK-390/395

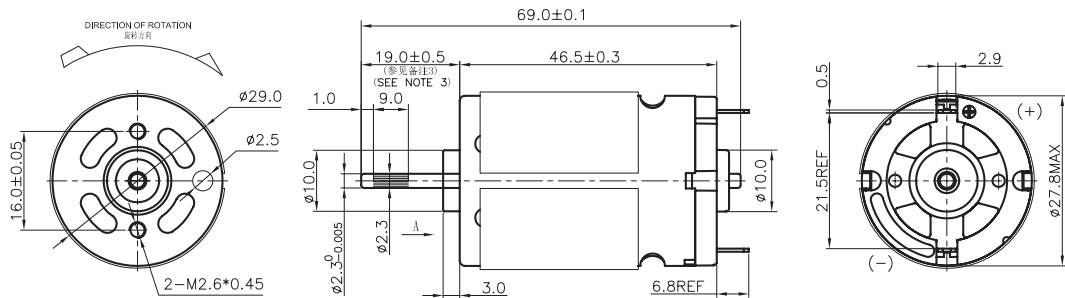

Typical Performance

DC-QRK-380DA-40045(7.2V)

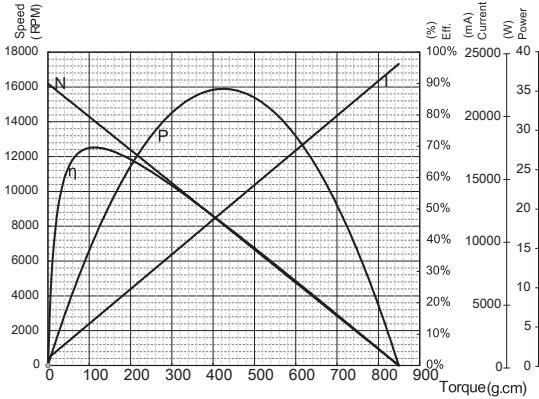

DC-QRK-385DA-20073(20V)

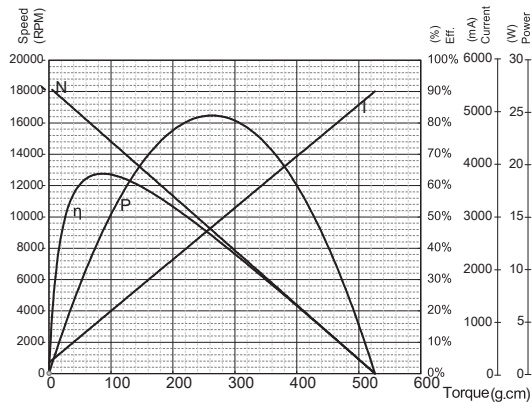

DC-QRK-385DH-16120(24V)

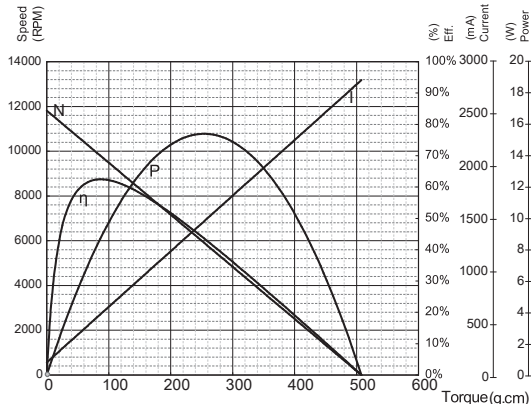

Japan Magnets.,Inc

Head Office / Japan Bldg 4F, 1-1646-2, Kamikawa, Suwa, Nagano, Japan zipcode 392-0021

Tel /+81-266-56-1021

Fax /+81-266-56-1430

HP / <http://www.jmi-motion.com>