

Housing ϕ 44mm DC Brush Motor xRK-750/755/ 770/775

OUTPUT : 50W~200W (APPROX)

BRUSH TYPE : カーボンブラシ /Graphite Brush Motor

WEIGHT(APPROX) : 268g(RK-750/755)/ 320g(RK-770/775)

代表的用途 /Typical Application

家電機器 / バキュームクリーナー、コンプレッサー、マッサージャ、ヘアドライヤ
 事務機器 / レーザプリンタ、複写・複合機
 DIY ツール / 電動ドライバー、
 自動車関連機器 /

Household App/ Vacuum Cleaner, Compressor, Massager, Hair Dryer
 Office Automation Equipment / Printer, Scanner,
 DIY Tool / Electric Tool
 Automotive Equipment / Compressor for Car

Motor Parameter

No.	Standard Model No.	Product No.	Outline Size			Rated Voltage	No Load		at Max Efficiency				at Stall			
			Motor OD	Housing Length	Shart OD		No Load Speed	No Load Current	Rated Speed	Rated Current	Rated Torque		Output	Starting Torque		Starting Current
			(mm)	(mm)	(mm)		(rpm)	(A)	(rpm)	(A)	(mN-m)	(g · cm)	(W)	(mN-m)	(g · cm)	(A)
Typical Grade xRK-750/755																
210	DC-QRK-750DH	85023	*44.0 with Yoke	60.5	5.0	6.0	13200	1.95	11400	12.49	43.11	439.89	51.46	319.24	3257.50	80.00
211	DC-QRK-750DH	80027			5.0	12.0	22500	2.30	19400	14.40	59.05	602.59	119.96	428.93	4376.80	90.23
212	DC-QRK-755DH	35070			5.0	24.0	8300	0.32	7100	1.96	43.69	445.80	32.48	311.23	3175.80	12.00
213	DC-QRK-755DH	21125			5.0	24.0	4300	0.18	3500	0.75	28.34	289.20	10.39	146.19	1491.70	3.12
214	DC-QRK-775DH	75013		67.0	5.0	12.0	18700	2.20	16100	13.70	67.68	690.57	114.09	490.10	5001.00	85.71
215	DC-TRK-750PH	9306	*44.4 with Yoke	59.0	5.0	6.0	14200	3.40	11800	17.10	61.74	630.00	46.24	365.30	3728.00	84.50
216	DC-TRK-750PH	8108			5.0	9.6	18400	1.80	15800	11.10	47.70	478.00	78.91	337.80	3447.00	67.70
217	DC-TRK-755PH	4440			5.0	3.6	1800	0.80	1300	2.10	22.50	230.70	3.14	86.30	880.00	6.30
218	DC-TRK-755PH	5149			5.0	24.0	10630	0.70	9080	3.20	58.80	600.00	55.87	403.30	4115.00	17.90
Typical Grade xRK-770/775																
219	DC-TRK-770PH	9007	*44.4 with Yoke	66.0	5.0	11.1	25000	4.20	21331	24.40	76.20	777.00	170.40	519.60	5300.00	142.00
220	DC-TRK-770PH	9120			5.0	12.0	20100	3.50	17000	19.00	88.20	900.00	161.50	681.10	6950.00	124.40
221	DC-TRK-775PH	8512			5.0	12.0	21600	2.00	18916	19.70	65.70	671.00	130.00	529.20	5400.00	139.00
222	DC-TRK-775PH	6713			5.0	7.4	12100	3.00	9885	12.70	47.50	485.00	49.10	259.70	2650.00	56.60
223	DC-TRK-775PH	5037			5.0	12.0	5375	0.50	4555	3.40	65.00	663.20	30.98	426.30	4350.00	22.50

Japan Magnets.,Inc

Head Office / Japan Bldg 4F, 1-1646-2, Kamikawa, Suwa, Nagano, Japan zipcode 392-0021

Tel /+81-266-56-1021

Fax /+81-266-56-1430

HP / <http://www.jmi-motion.com>

Housing ϕ 44mm DC Brush Motor xRK-750/755/ 770/775

OUTLINE

DC-QRK-750/755

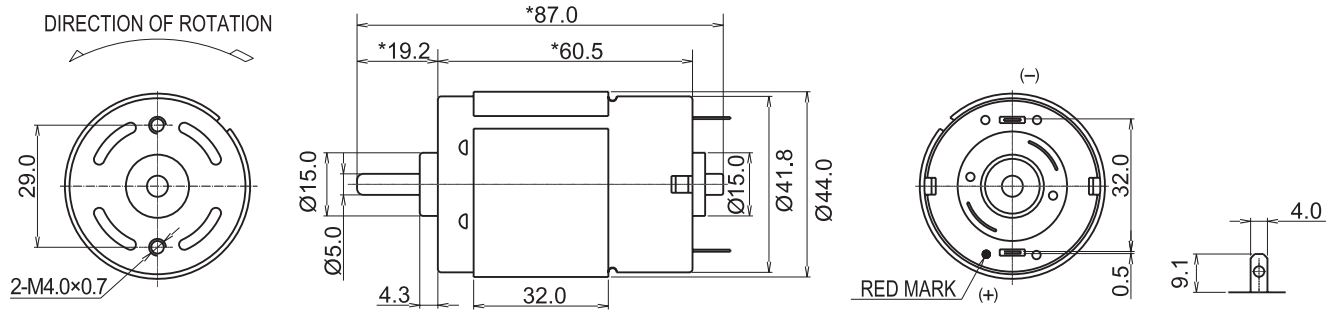

DC-QRK-770/775

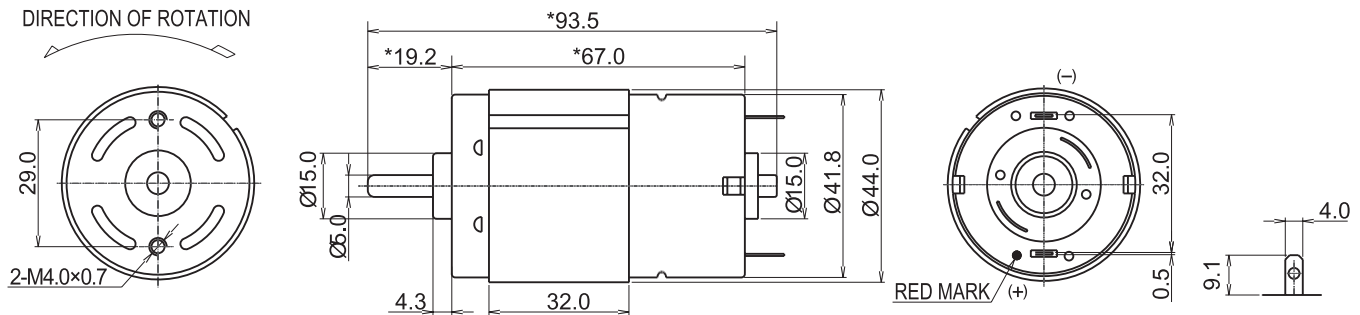

Typical Performance

DC-QRK-755DH-35070(24V)

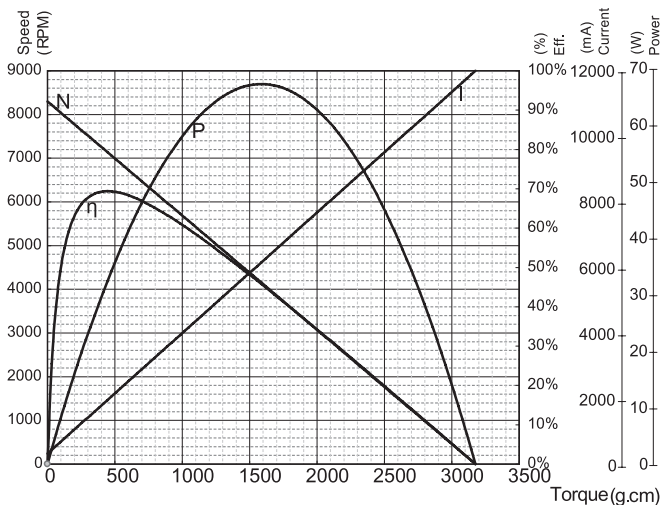

DC-QRK-775DH-75013(12V)

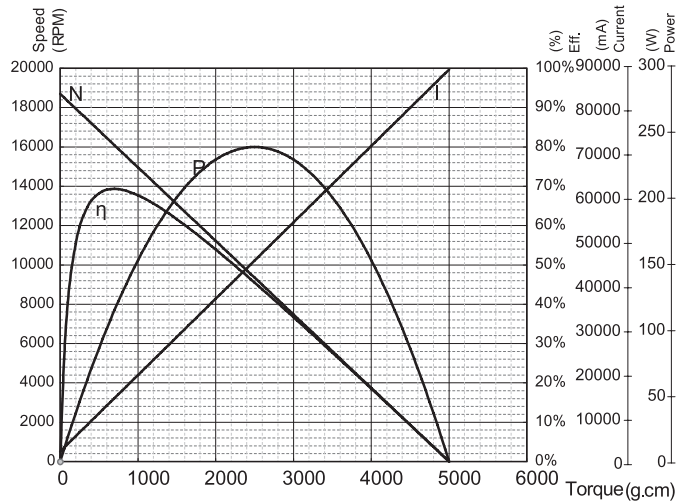

Japan Magnets.,Inc

Head Office / Japan Bldg 4F, 1-1646-2, Kamikawa, Suwa, Nagano, Japan zipcode 392-0021

Tel /+81-266-56-1021

Fax /+81-266-56-1430

HP / <http://www.jmi-motion.com>